

BOLLETTINO TECNICO

TECHNICAL INFORMATION - CIRCULAIRE TECHNIQUE – BOLETÍN TECNICO

PRODOTTI COINVOLTI: IDROPULITRICI PROFESSIONALI CON POMPE CL5

PRODUCTS INVOLVED: PROFESSIONAL H.P. CLEANERS WITH CL5 PUMPS

PRODUITS IMPLIQUÉS : PROFESSIONNEL H.P. NETTOYEURS AVEC POMPES CL5

PRODUCTOS IMPLICADOS: PROFESIONAL H.P. LIMPIADORES CON BOMBAS CL5

OGGETTO: SOSTITUZIONE VALVOLA DI REGOLAZIONE L3 CON L3.1

OBJECT: REPLACEMENT OF THE L3 UNLOADER VALVE WITH L3.1

OBJET : REMPLACEMENT DE LA VANNE DE RÉGULATION L3 PAR L3.1

ASUNTO: SUSTITUCIÓN DE LA VÁLVULA REGULADORA L3 POR L3.1

DESCRIZIONE TECNICA

TECHNICAL DESCRIPTION

DESCRIPTION TECHNIQUE

DESCRIPCIÓN TÉCNICA

Le valvole L3 sono uscite di produzione, vengono sostituite dalle nuove valvole L3.1 (immagine sotto). Sono stati realizzati kit per la sostituzione delle vecchie valvole L3 con le nuove L3.1 sulle pompe Lavor CL5.

The L3 valves are out of production, they are replaced by the new L3.1 valves (image below). Kits have been created for replacing the old L3 valves with the new L3.1 on Lavor CL5 pumps.

Les vannes L3 sont hors production, elles sont remplacées par les nouvelles vannes L3.1 (image ci-dessous). Des kits ont été créés pour remplacer les anciennes vannes L3 par les nouvelles L3.1 sur les pompes Lavor CL5.

Las válvulas L3 están fuera de producción, son reemplazadas por las nuevas válvulas L3.1 (imagen abajo). Se han creado kits para reemplazar las antiguas válvulas L3 por las nuevas L3.1 en las bombas Lavor CL5.

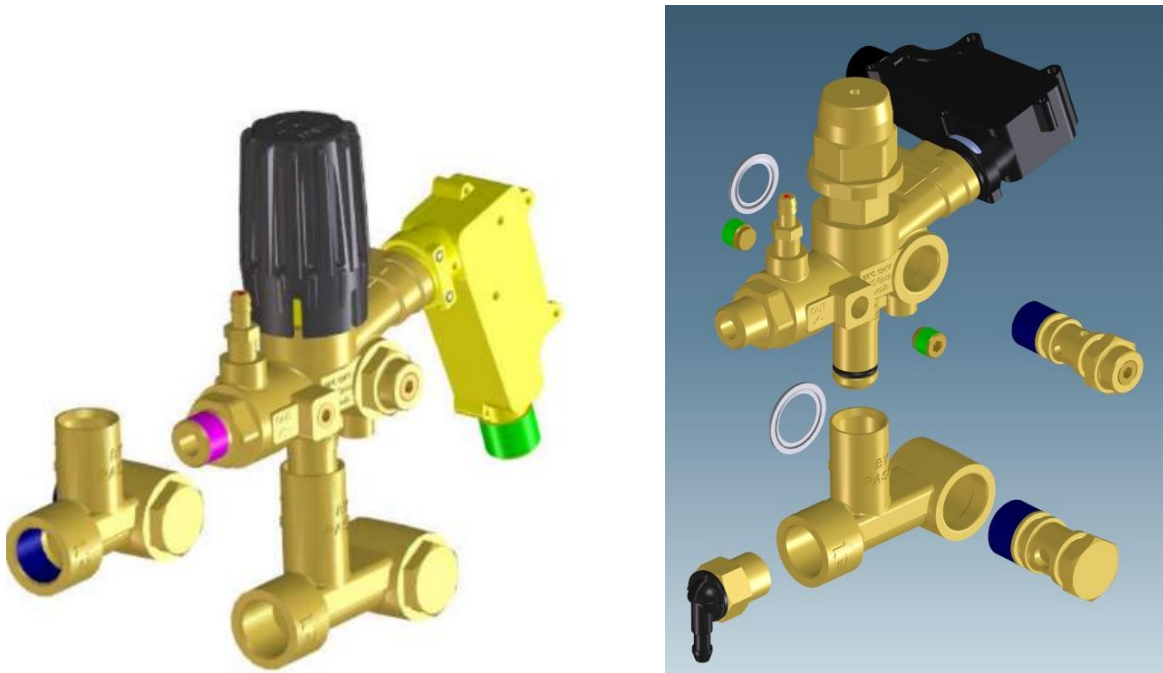

I vecchi codici KIT ricambi valvole L3 sono fuori produzione e non è possibile effettuare nuovi ordini:

Old L3 valves KIT spare parts codes are out of production and new orders cannot be placed:

Les anciens codes de pièces détachées KIT vannes L3 ne sont plus en production et de nouvelles commandes ne peuvent pas être passées :

Los antiguos códigos de repuestos del KIT de válvulas L3 están fuera de producción y no se pueden realizar nuevos pedidos:

Codice articolo	Descrizione articolo
6.605.0078	KIT VALVOLA L3 C/TS C/IN. 2,3
6.605.0080	KIT VALVOLA L3 C/TS S/IN.
6.605.0081	KIT VALVOLA L3 S/TS C/IN.2,3
6.605.0085	KIT VALVOLA L3 C/TS C/IN. 2,0
6.605.0252	KIT VALVOLA L3 C/TS S/IN. X R..VAP.

Sono stati creati nuovi codici KIT ricambio completi per il montaggio di valvola L3.1 su pompa CL5. Ogni KIT è specifico per tipo di applicazione e modello Idropulitrice:

New complete spare KIT codes have been created for mounting the L3.1 valve on the CL5 pump. Each KIT is specific to the type of application and pressure washer model:

De nouveaux codes KIT de rechange complets ont été créés pour le montage de la vanne L3.1 sur la pompe CL5. Chaque KIT est spécifique au type d'application et au modèle de nettoyeur haute pression :

Se han creado nuevos códigos de KIT de repuesto completo para montar la válvula L3.1 en la bomba CL5. Cada KIT es específico para el tipo de aplicación y modelo de hidrolimpiadora:

10001-12883	KIT VRA S/INIET TS + COLL 4,5 + VALV.SIC 17-21 l/min
10001-12884	KIT VRA S/INIET TS + COLL 4,5 + VALV.SIC 12-17 l/min
10001-12885	KIT VRA S/INIET TS + COLL 19 + VALV.SIC 17-21 l/min
10001-12886	KIT VRA S/INIET TS + COLL 19 + VALV.SIC 12-17 l/min
10001-12890	KIT VRA 2,0 TS + COLL 19 + MANOP + VALV.TERM
10001-12892	KIT VRA S/INIET TS + COLL 19 + MANOP + VALV.TERM
10001-12894	KIT VRA 2,0 S/TS + COLL 19 + MANOP + VALV.TERM
10001-12898	KIT VRA S/INIET TS + COLL 19 + VALV.SIC 17-21 l/min C/1/8
10001-12899	KIT VRA S/INIET TS + COLL 19 + VALV.SIC 12-17 l/min C/1/8
10001-13492	KIT VRA 2,0 TS + COLL 4,5 + VALV.SIC 12-17 l/min
10001-13494	KIT VRA 2,0 TS + COLL 4,5 + VALV.SIC 12-17 l/min C/1/8
10001-13495	KIT VRA 2,0 TS + COLL 4,5 + VALV.SIC 17-21 l/min
10001-13496	KIT VRA 2,0 TS + COLL 4,5 + VALV.SIC 17-21 l/min C/1/8

Questa tabella mostra la corrispondenza della nuova valvola L3.1 (KIT COMPLETO) per ogni modello di idropulitrice:

This table shows the correspondence of the new L3.1 valve (COMPLETE KIT) for each pressure washer model:

Ce tableau présente la correspondance de la nouvelle vanne L3.1 (KIT COMPLET) pour chaque modèle de nettoyeur haute pression :

En esta tabla se muestra la correspondencia de la nueva válvula L3.1 (KIT COMPLETO) para cada modelo de hidrolimpiadora:

			L3 VALVES FOR OLD CL5 PUMP		
HP CLEANER	FLOW-RATE	VALVE TYPE	OLD CODE L3 VALVE	OLD CODE L3 SPARE PART	COMPLETE UNLOADER VALVE L3.1 SET
	l/min				
LKX / HLR (8.621) 15 litri / litres / litros	15	injector	5.609.0181 I2,3 TS	66050078	10001-13492
		no injector	5.609.0183 S/I TS	66050080	10001-12884
		injector + steam	5.609.0181 I2,3 TS	66050252	10001-13494
LKX / HLR (8.621) 21 litri / litres / litros	21	injector	5.609.0181 I2,3 TS	66050078	10001-13495
		no injector	5.609.0183 S/I TS	66050080	10001-12883
		injector + steam	5.609.0181 I2,3 TS	66050252	10001-13496
Tekna (8.622) / HTR (8.623) 15 litri / litres / litros	15	no injector	5.609.0183 S/I TS	66050080	10001-12886
		no injector + steam	5.609.0183 S/I TS	66050252	10001-12899
Tekna (8.622) / HTR (8.623) 21 litri / litres / litros	21	no injector	5.609.0183 S/I TS	66050080	10001-12885
		no injector + steam	5.609.0183 S/I TS	66050252	10001-12898
HHPV (8.624) 15 litri / litres / litros	15	no injector	5.609.0183 S/I TS	66050080	10001-12886
		no injector + steam	5.609.0183 S/I TS	66050252	10001-12899
HHPV (8.624) 21 litri / litres / litros	21	no injector	5.609.0183 S/I TS	66050080	10001-12885
		no injector + steam	5.609.0183 S/I TS	66050252	10001-12898
MCHP (8.626) 15/21 litri / litres / litros	15	no injector	5.609.0183 S/I TS	66050080	10001-12892
MCHP (8.626) 15 litri / litres / litros	15	injector	5.609.0248 I2,0 TS	66050085	10001-12890
Columbia (8.654) - Thermic (8.601) 15 litri / litres / litros	15	injector no TS	5.609.0189 I2,3 S/TS	66050081	10001-12894
Columbia (8.654) - Thermic (8.601) 21 litri / litres / litros	21	injector no TS	5.609.0189 I2,3 S/TS	66050081	10001-12894
Columbia (8.654) / KCR (8.674) 15 litri / litres / litros	15	injector	5.609.0181 I2,3 TS	66050078	10001-12890
Columbia (8.654) / KCR (8.674) 21 litri / litres / litros	21	injector	5.609.0181 I2,3 TS	66050078	10001-12890
Columbia (8.654) 15/21 litri / litres / litros	21	no injector	5.609.0183 S/I TS	66050080	10001-12892
Tucson XL (8.672) 15 litri / litres / litros	15	injector	5.609.0181 I2,3 TS	66050078	10001-12890
Tucson XL (8.672) 21 litri / litres / litros	21	injector	5.609.0181 I2,3 TS	66050078	10001-12890

Injector: con iniettore detergente No injector: senza iniettore detergente Steam: con funzione vapore NO TS: senza Total Stop	Injector: with detergent injector No injector: without detergent injector Steam: with steam function NO TS: without Total Stop
Injector: avec injecteur de détergent NO Injector: sans injecteur de détergent Steam: avec fonction vapore NO TS: sans Total Stop	Injector: con inyector de detergente No injector: sin inyector de detergente. Steam: con función vapor NO TS: sin Total Stop

I nuovi KIT valvola COMPLETI sono composti da altri KIT di montaggio per le relative applicazioni pompa / idropulitrici (notare bene i colori):

The new COMPLETE valve KITS are composed of other assembly KITS for the relevant pump / pressure washer applications (note the colours):

Les nouveaux KITS COMPLETS de vannes sont composés d'autres KITS de montage pour les applications pompes / nettoyeurs haute pression pertinentes (notez les couleurs) :

Los nuevos KITS COMPLETOS de válvulas se componen de otros KITS de montaje para las correspondientes aplicaciones de bomba/limpiadora a presión (tenga en cuenta los colores):

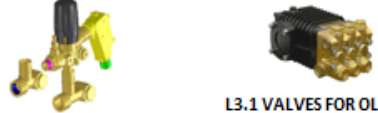
			 L3.1 VALVES FOR OLD CL5 PUMP				
HP CLEANER	FLOW-RATE	VALVE TYPE	COMPLETE UNLOADER VALVE L3.1 SET	COMPOSED BY			
	l/min			COMPLETE UNLOADER VALVE BODY	BY-PASS MANIFOLD KIT	SAFETY VALVE ASSEMBLY KIT	THERMOSTATIC VALVE
LKX / HLR (8.621) 15 litri / litres / litros	15	injector	10001-13492	10002-14546	10001-13104	10001-13469	NO
		no injector	10001-12884	10002-14547	10001-13104	10001-13469	NO
		injector + steam	10001-13494	10002-14546	10001-13106	10001-13469	NO
LKX / HLR (8.621) 21 litri / litres / litros	21	injector	10001-13495	10002-14546	10001-13104	10001-13470	NO
		no injector	10001-12883	10002-14547	10001-13104	10001-13470	NO
		injector + steam	10001-13496	10002-14546	10001-13106	10001-13470	NO
Tekna (8.622) / HTR (8.623) 15 litri / litres / litros	15	no injector	10001-12886	10002-14547	10001-13105	10001-13469	NO
		no injector + steam	10001-12899	10002-14547	10001-13107	10001-13469	NO
Tekna (8.622) / HTR (8.623) 21 litri / litres / litros	21	no injector	10001-12885	10002-14547	10001-13105	10001-13470	NO
		no injector + steam	10001-12898	10002-14547	10001-13107	10001-13470	NO
HHPV (8.624) 15 litri / litres / litros	15	no injector	10001-12886	10002-14547	10001-13105	10001-13469	NO
		no injector + steam	10001-12899	10002-14547	10001-13107	10001-13469	NO
HHPV (8.624) 21 litri / litres / litros	21	no injector	10001-12885	10002-14547	10001-13105	10001-13470	NO
		no injector + steam	10001-12898	10002-14547	10001-13107	10001-13470	NO
MCHP (8.626) 15/21 litri / litres / litros	15	no injector	10001-12892	10002-14547	10001-13105	NO	10002-01130
MCHP (8.626) 15 litri / litres / litros	15	injector	10001-12890	10002-14546	10001-13105	NO	10002-01130
Columbia (8.654) - Thermic (8.601) 15 litri / litres / litros	15	injector no TS	10001-12894	10002-14698	10001-13105	NO	10002-01130
Columbia (8.654) - Thermic (8.601) 21 litri / litres / litros	21	injector no TS	10001-12894	10002-14698	10001-13105	NO	10002-01130
Columbia (8.654) / KCR (8.674) 15 litri / litres / litros	15	injector	10001-12890	10002-14546	10001-13105	NO	10002-01130
Columbia (8.654) / KCR (8.674) 21 litri / litres / litros	21	injector	10001-12890	10002-14546	10001-13105	NO	10002-01130
Columbia (8.654) 15/21 litri / litres / litros	21	no injector	10001-12892	10002-14547	10001-13105	NO	10002-01130
Tucson XL (8.672) 15 litri / litres / litros	15	injector	10001-12890	10002-14546	10001-13105	NO	10002-01130
Tucson XL (8.672) 21 litri / litres / litros	21	injector	10001-12890	10002-14546	10001-13105	NO	10002-01130

Dettaglio composizione KIT COMPLETO e KIT di MONTAGGIO:

COMPLETE KIT and ASSEMBLY KIT Composition detail:

Détail de la composition KIT COMPLET et KIT DE MONTAGE:

Detalle de composición KIT COMPLETO y KIT DE MONTAJE:

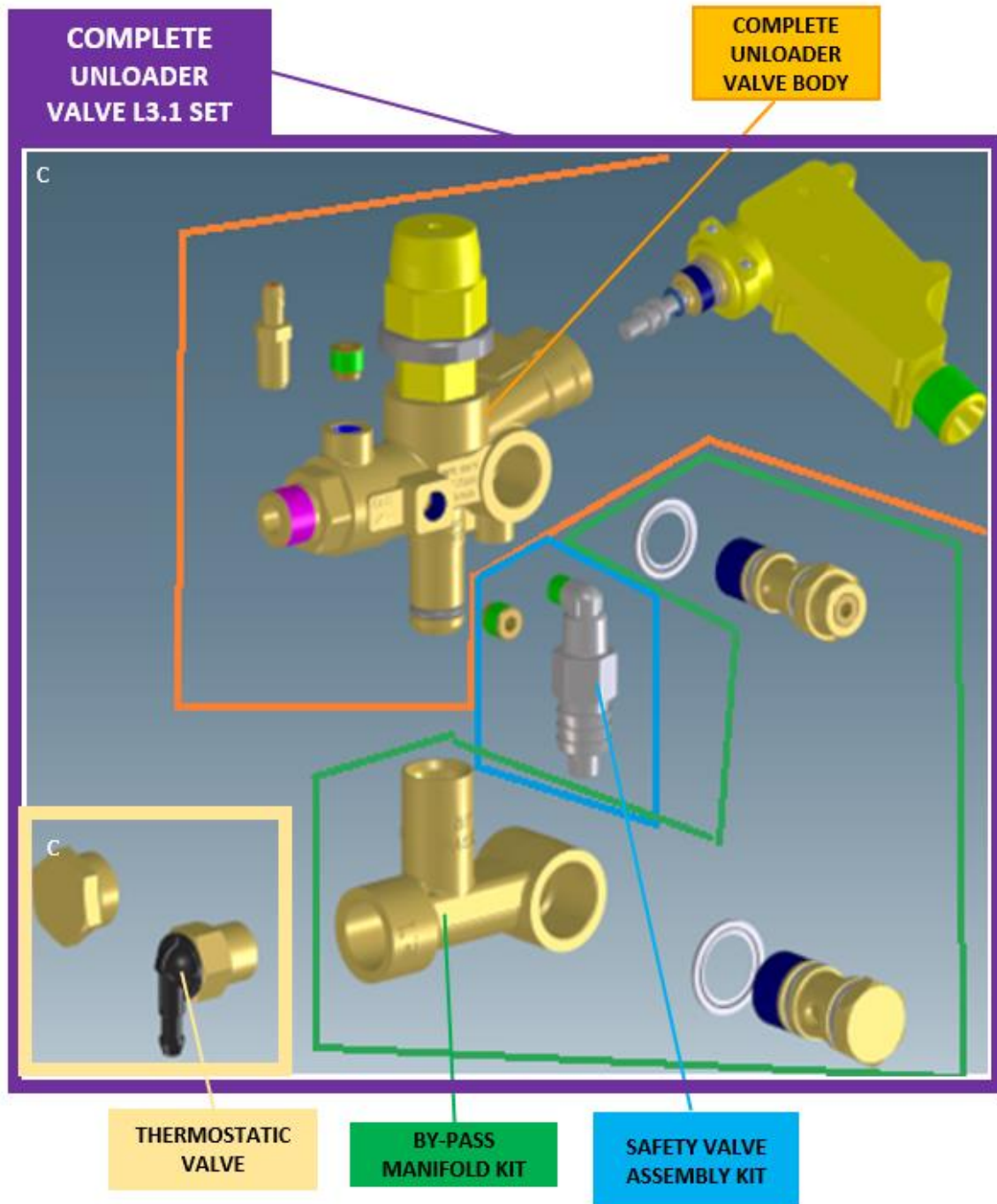

1. Complete unloaded valve (3 KITS)

10002-14546

10002-14547

10002-14698

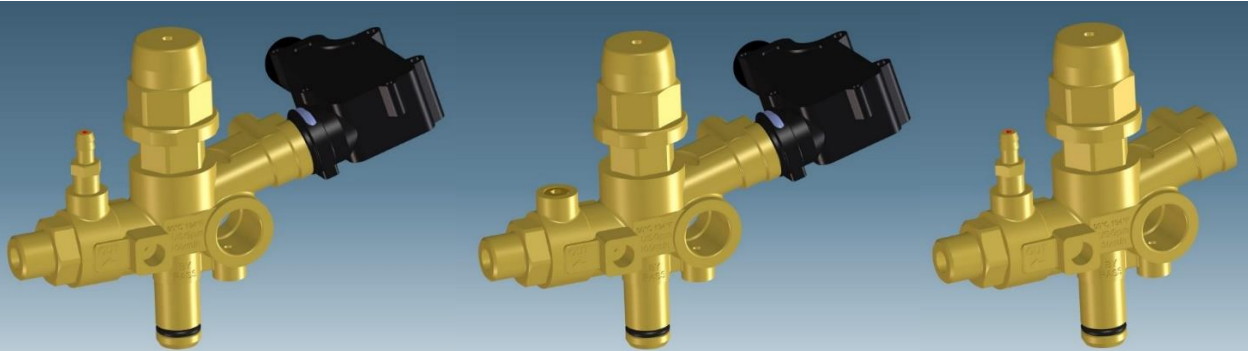

2. By-pass manifold with screws and caps (4 KITS)

10001-13104 (4,5mm) - 10001-13105 (19mm)

10001-13106 (4,5+1/8" F) - 10001-13107 (19+1/8" F)

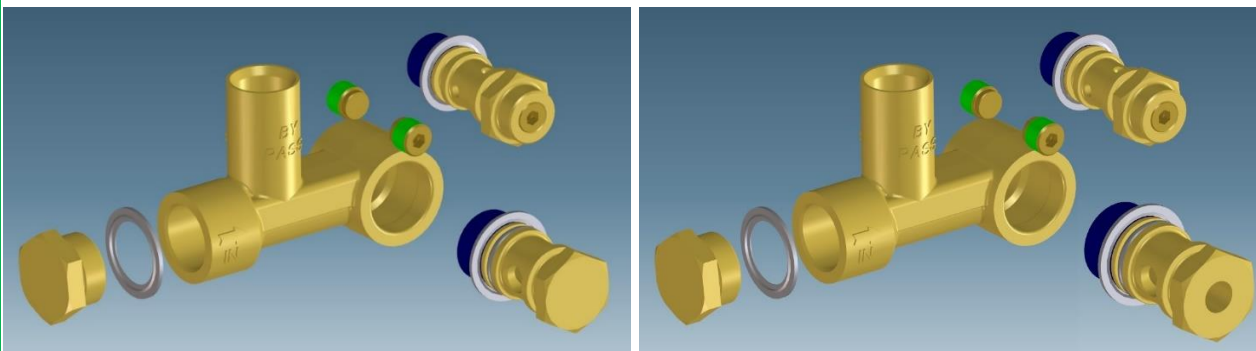

3. Safety valve assembly (2 KITS)

10001-13469 (12/17 l/min) - 10001-13470 (17/21 l/min)

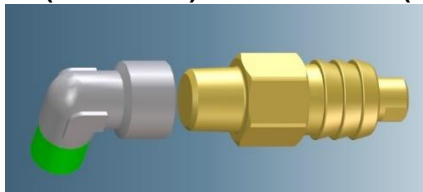

4. Thermostatic valve (1 KITS)

10002-01130



Istruzioni di montaggio per idropultrici ad acqua fredda
Assembly instructions for cold water pressure washers
Instructions de montage pour nettoyeurs haute pression à eau froide
Instrucciones de montaje para hidrolimpiadoras de agua fría

8.601 – 8.626 – 8.654 – 8.672 – 8.674:

Dopo aver rimosso la vecchia valvola L3, montare la nuova valvola L3.1

After removing old L3 valve, assembly the new L3.1 valve as shown below

Après avoir retiré l'ancienne vanne L3, assemblez la nouvelle vanne L3.1

Después de retirar la válvula L3 antigua, monte la nueva válvula L3.1

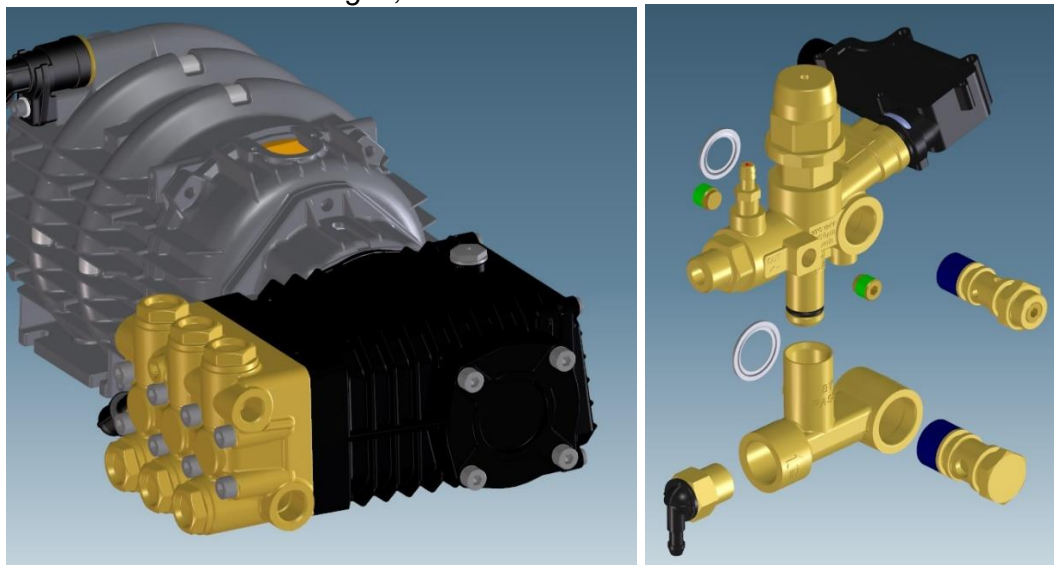

Installare la valvola sulla pompa, serrando le viti con una coppia consigliata di 35 Nm

Install the valve to the pump, tightening screws with a suggested torque of 35 Nm

Installez la vanne sur la pompe en serrant les vis avec un couple suggéré de 35 Nm

Instale la válvula en la bomba, apretando los tornillos con un par sugerido de 35 Nm

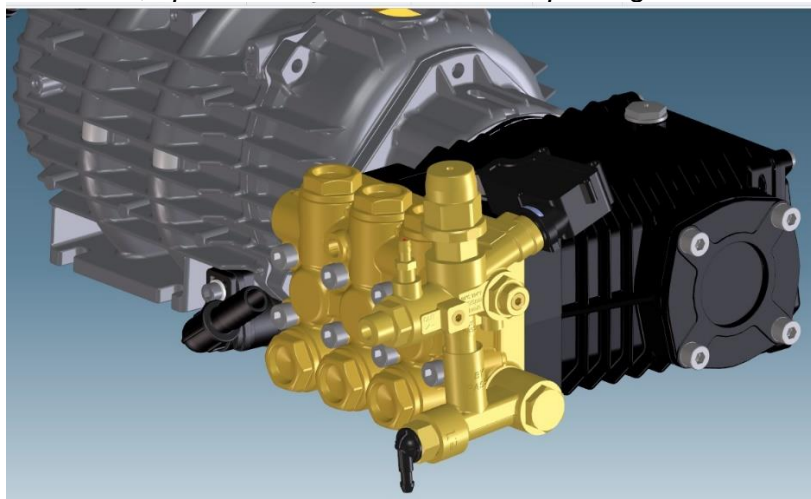

Istruzioni di montaggio per idropulitrici ad acqua calda
Assembly instructions for hot water pressure washers
Instructions de montage pour nettoyeurs haute pression à eau chaude
Instrucciones de montaje para hidrolimpiadoras de agua caliente

8.621 (LKX/HLR) – 8.624 (HHPV):

Dopo aver rimosso la vecchia valvola L3, montare la nuova valvola L3.1
After removing old L3 valve, assembly the new L3.1 valve as shown below
Après avoir retiré l'ancienne vanne L3, assemblez la nouvelle vanne L3.1
Después de retirar la válvula L3 antigua, monte la nueva válvula L3.1

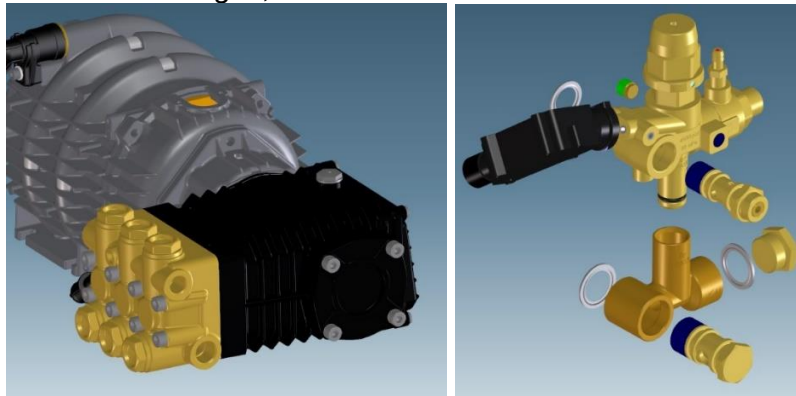

Installare la valvola sulla pompa, serrando le viti con una coppia consigliata di 35 Nm
Install the valve to the pump, tightening screws with a suggested torque of 35 Nm
Installez la vanne sur la pompe en serrant les vis avec un couple suggéré de 35 Nm
Instale la válvula en la bomba, apretando los tornillos con un par sugerido de 35 Nm

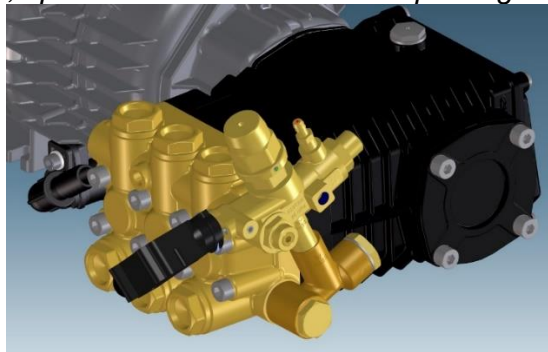

Installare la valvola di sicurezza sulla valvola di regolazione L3.1, utilizzando Loctite 243
Install the safety valve to the L3.1 unloader valve, using Loctite 243:
Installez la soupape de sécurité sur la soupape de décharge L3.1 à l'aide de Loctite 243
Instale la válvula de seguridad en la válvula de descarga L3.1, usando Loctite 243

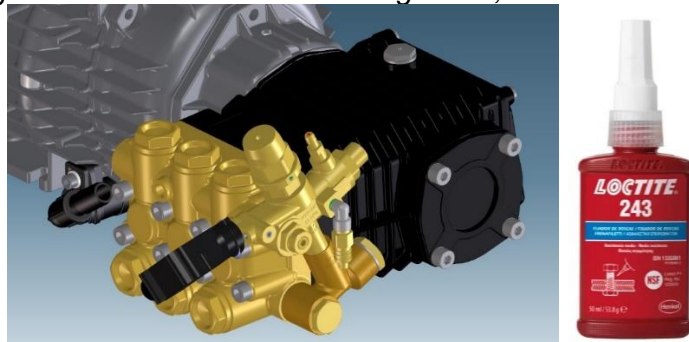

Istruzioni di montaggio per idropulitrici ad acqua calda
Assembly instructions for hot water pressure washers
Instructions de montage pour nettoyeurs haute pression à eau chaude
Instrucciones de montaje para hidrolimpiadoras de agua caliente
8.622 – 8.623 (Tekna / HTR):

Dopo aver rimosso la vecchia valvola L3, montare la nuova valvola L3.1

After removing old L3 valve, assembly the new L3.1 valve as shown below

Après avoir retiré l'ancienne vanne L3, assemblez la nouvelle vanne L3.1

Después de retirar la válvula L3 antigua, monte la nueva válvula L3.1 After removing old L3 valve, assembly the new L3.1 valve as shown below:

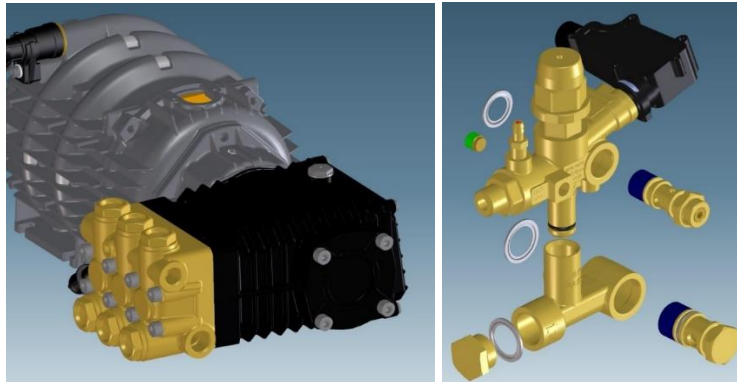

Installare la valvola sulla pompa, serrando le viti con una coppia consigliata di 35 Nm

Install the valve to the pump, tightening screws with a suggested torque of 35 Nm

Installez la vanne sur la pompe en serrant les vis avec un couple suggéré de 35 Nm

Instale la válvula en la bomba, apretando los tornillos con un par sugerido de 35 Nm

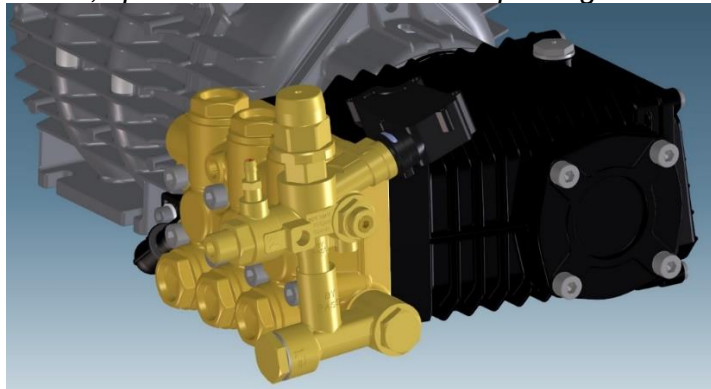

Installare la valvola di sicurezza sulla valvola di regolazione L3.1, utilizzando Loctite 243

Install the safety valve to the L3.1 unloader valve, using Loctite 243:

Installez la soupape de sécurité sur la soupape de décharge L3.1 à l'aide de Loctite 243

Instale la válvula de seguridad en la válvula de descarga L3.1, usando Loctite 243

