



ASPIR.JOKER 1400S WET&DRY 220-240~50/60 -LAVOR- (IT/FR/ES/EN)

Filtri: validità 05/08/2021

05/08/2021

8.251.0002 - ASPIR.JOKER 1400S WET&DRY 220-240~50/60 -LAVOR- (IT/FR/ES/EN).....	3
R82510002 - ASPIR.JOKER 1400S WET&DRY 220-240~50/60 -LAVOR- (IT/FR/ES/EN).....	4
R52110118C - ASSIEME TESTATA DVC -N/V- 230/50 SP.SCHUKO.....	6
Indice componenti.....	8

Pos.	Codice	Descrizione
0	R82510002	ASPIR.JOKER 1400S WET&DRY 220-240~50/60 -LAVOR- (IT/FR/ES/EN)

D82510002/01

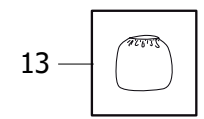
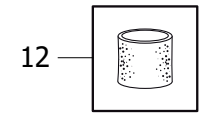
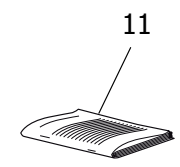
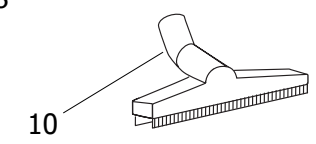
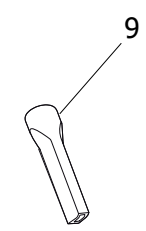
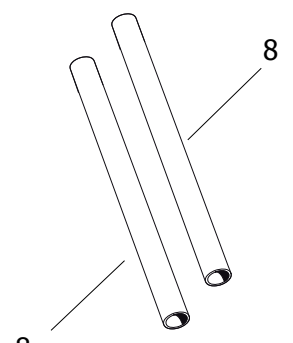
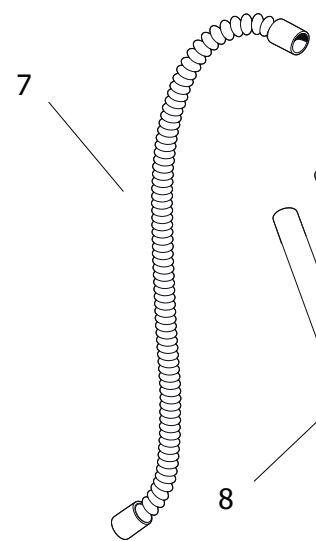
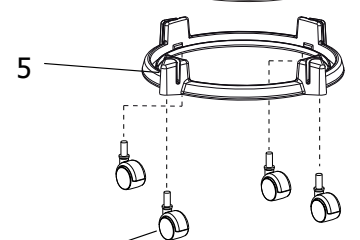
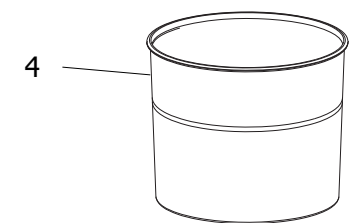
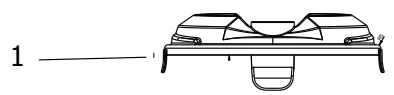

Pos.	Codice	Sostituito da	Q.tà	Acquistabile	Q.tà min.	Per manuten.	Descrizione
0	R52110118C		1	No			ASSIEME TESTATA DVC -N/V- 230/50 SP.SCHUKO
001	4.208.0719		1	Si	1		ADATTATORE TESTA ASP. DVC P82.0655
002	4.208.0730		1	Si	1		GALLEGGIANTE JOKER (P82.0655)
003	4.208.0703		1	Si	1		CESTELLO PER GALLEGGIANTE DVC (P82.0655)
004	3.751.0115		1	Si	1		FUSTO ACCIAIO 20LT S/FORI X VAC C/SERIGRAFIA -LAVOR-/MADE IN ITALY (RUDY)
005	4.208.0531		1	Si	1		BASE PORTA RUOTE FUSTO ACCIAIO (4 RUOTE)
006	3.754.0199		4	Si	1	EXT	RUOTE GEMELLATE PIVOTANTI D.40 -N- PERNO ACCIAIO C/CUFFIA LARGA -RPC-
007	3.753.0121		1	Si	1	EXT	TUBO FLEX 1,5mt C/IMP.DIRITTA (X VAC P82.0531)
008	3.753.0072		2	Si	1		TUBO PROLUNGA LISCIO MT.0,48 D .35 (SPEC.)
009	3.754.0005		1	Si	1	EXT	LANCIA PIATTA D.35
010	3.754.0249		1	Si	1		SPAZZOLA POLVERE/LIQUIDI ECO D.35
011	7.300.0696		1	Si	1		MANUALE ASPIRATORE JOKER +CE LWS (ITA/EN/FR/ES) A5 16F
012	5.212.0030		1	Si	1		KIT 1 FILTRO SPUGNA X GT -LAVOR-
013	5.212.0167		1	No			KIT 3 FILTRI PANNI X ASPIRACENERE -LAVOR-

D52110008/01

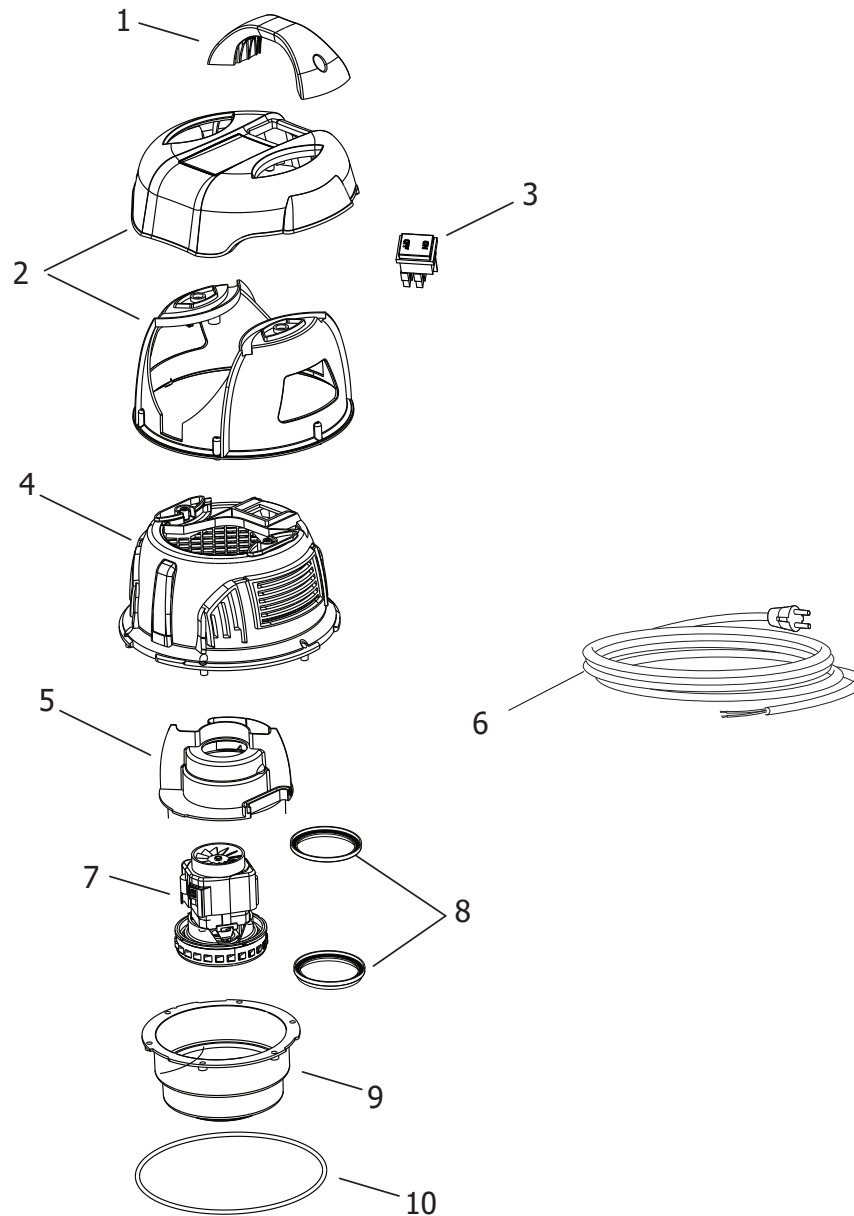

ASPIR.JOKER 1400S WET&DRY 220-240-50/60 -LAVOR- (IT/FR/ES/EN) - Filtri: validità 05/08/2021

R52110118C - ASSIEME TESTATA DVC -N/V- 230/50 SP.SCHUKO

Validità: dal 07/12/2016 al 31/12/9999

Pos.	Codice	Sostituito da	Q.tà	Acquistabile	Q.tà min.	Per manuten.	Descrizione
001	5.212.0147		1	Si	1		KIT 1 MANIGLIA + 2 VITI PER DVC (P82.0655)
002	5.211.0119		1	No			ASSIEME COPERTURE SUPERIORI DVC -N/V-
003	5.009.0213		1	Si	1	EXT	ASSIEME INTERR. 0/1 BIP. 12(10)A +PROTEZ.TRASPARENTE
004	4.208.0699		1	No			CALOTTA SUPERIORE DVC (P82.0655)
005	4.208.0700		1	No			CONVOGLIATORE MOTORE DVC (P82.0655)
006	5.209.0217		1	Si	1		ASSIEME CAVO H05VV-F 2X0,75 MT.4 SP.SCHUKO +PASSACAVO K13
007	3.755.0115		1	Si	1	EXT	MOTORE SPAZZ. PER DVC 20 220-240/50-60 900W(P82.0655)
008	4.215.0142		2	No			GUARNIZIONE MOTORE Di.106XDe.109X14 PER DVC (P52.0655)
009	4.208.0701		1	No			CALOTTA INFERIORE DVC (P82.0655)
010	4.215.0143		1	No			GUARNIZIONE PER CALOTTA INFERIORE 152X3.6 DVC (P82.0655)

Codice	Tavola	Pos.	Q.tà
3.751.0115	R82510002	004	1
3.753.0072	R82510002	008	2
3.753.0121	R82510002	007	1
3.754.0005	R82510002	009	1
3.754.0199	R82510002	006	4
3.754.0249	R82510002	010	1
3.755.0115	R52110118C	007	1
4.208.0531	R82510002	005	1
4.208.0699	R52110118C	004	1
4.208.0700	R52110118C	005	1
4.208.0701	R52110118C	009	1
4.208.0703	R82510002	003	1
4.208.0719	R82510002	001	1
4.208.0730	R82510002	002	1
4.215.0142	R52110118C	008	2
4.215.0143	R52110118C	010	1
5.009.0213	R52110118C	003	1
5.209.0217	R52110118C	006	1
5.211.0119	R52110118C	002	1
5.212.0030	R82510002	012	1
5.212.0147	R52110118C	001	1
5.212.0167	R82510002	013	1
7.300.0696	R82510002	011	1